

REVISIONS			
REV.	DESCRIPTION	DATE	APPROVED
-	AS PER E.C.O.# VPCT-310	FEB. 21-05	A.C.
A	AS PER E.C.O.# VPCT-330		

" J1" AIRCRAFT POWER D38999/24WD97PN (JAM NUT)		
	PIN	SIZE
A	CHASSIS GROUND	20
B	SPARE	20
C	115 VAC NEUTRAL	16
D	+28 VDC RTN.	20
E	+28 VDC INPUT	20
F	OPERATE +28 VDC	20
G	115 VAC PHASE A	16
H	SIU POWER TEST RELAY	20
J	SPARE	20
K	SHIELD	20
L	115 VAC PHASE B	16
M	115 VAC PHASE C	16

MATING CONNECTOR: D38999/26WD97SN
w/ M85049/38SDW BACKSHELL

" J2" IPU POWER D38999/24WD19SN (JAM NUT)		
	PIN	SIZE
A	CHASSIS GROUND	20
B	115 VAC NEUTRAL	20
C	115 VAC PHASE A	20
D	115 VAC PHASE B	20
E	115 VAC PHASE C	20
F	OPERATE +28 VDC	20
G	+28 VDC	20
H	SPARE	20
J	+28 VDC RTN.	20
K	STAB/SIU POWER CONTROL	20
L	SHUT/COOLER POWER CNTL	20
M	TE1 POWER CONTROL	20
N	TE2 POWER CONTROL	20
P	OVP SENSE	20
R	N/C	20
S	CC COOLER POWER CONTROL	20
T	RMS + 5 VDC DIGITAL	20
U	SHIELD	20
V	RMS +5 VDC RTN.	20

MATING CONNECTOR: D38999/26WD19PN
w/ M85049/38SDW BACKSHELL

" J3" SIU POWER D38999/24WJ24SN (JAM NUT)		
	PIN	SIZE
A	CHASSIS GROUND	12
B	+60 VDC RTN.	12
C	DC SHIELD	16
D	+60 VDC	12
E	SPARE	12
F	+48 VDC RTN.	16
G	+48 VDC	16
H	115 VAC PHASE A	16
J	115 VAC PHASE B	16
K	115 VAC PHASE C	16
L	28 VDC SHUTTER RTN.	12
M	+28 VDC SHUTTER	12
N	TEMP SENSOR POS	16
P	28 VDC IR COOLER RTN.	12
R	+28 VDC IR COOLER	12
S	115 VAC NEUTRAL	12
T	SPARE	12
U	TE1 RTN.	16
V	TE2 RTN.	16
W	CC COOLER RTN.	16
X	SPARE	12
Y	SPARE	12
Z	TEMP SENSOR NEG.	16

MATING CONNECTOR: D38999/26WJ24PN
w/ M85049/38SJW BACKSHELL

" J4" INS POWER D38999/24WD5SN (JAM NUT)		
	PIN	SIZE
A	CHASSIS GROUND	16
B	+28 VDC	16
C	+28 RTN.	16
D	N/C	16
E	N/C	16

MATING CONNECTOR: D38999/26WD5PN
w/ M85049/38SDW BACKSHELL

" J5" MFD POWER D38999/24WD5SB (JAM NUT)		
	PIN	SIZE
A	CHASSIS GROUND	16
B	N/C	16
C	+28 RTN. AIRCRAFT	16
D	MFD CONTROL	16
E	UN SWITCHED +28VDC	16

MATING CONNECTOR: D38999/26WD5PB
w/ M85049/38SDW BACKSHELL

" J6" SSR POWER D38999/24WD5SD (JAM NUT)		
	PIN	SIZE
A	CHASSIS GROUND	16
B	+28 VDC	16
C	+28 RTN.	16
D	N/C	16
E	N/C	16

MATING CONNECTOR: D38999/26WD5PD
w/ M85049/38SDW BACKSHELL

WEIGHT ≤ 20 LBS.

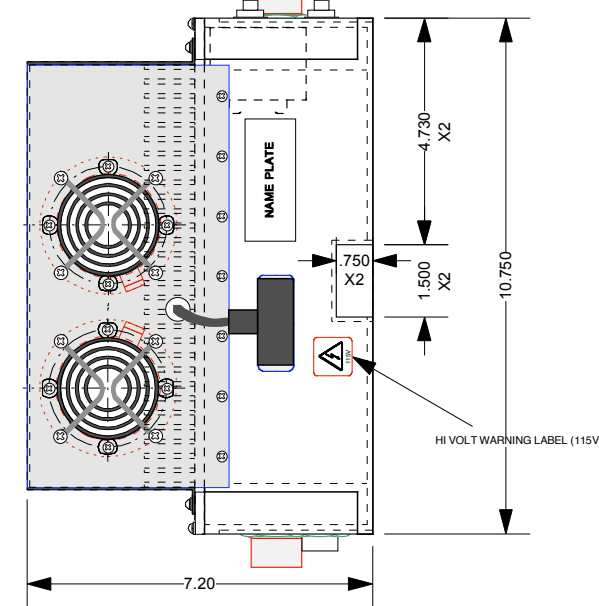
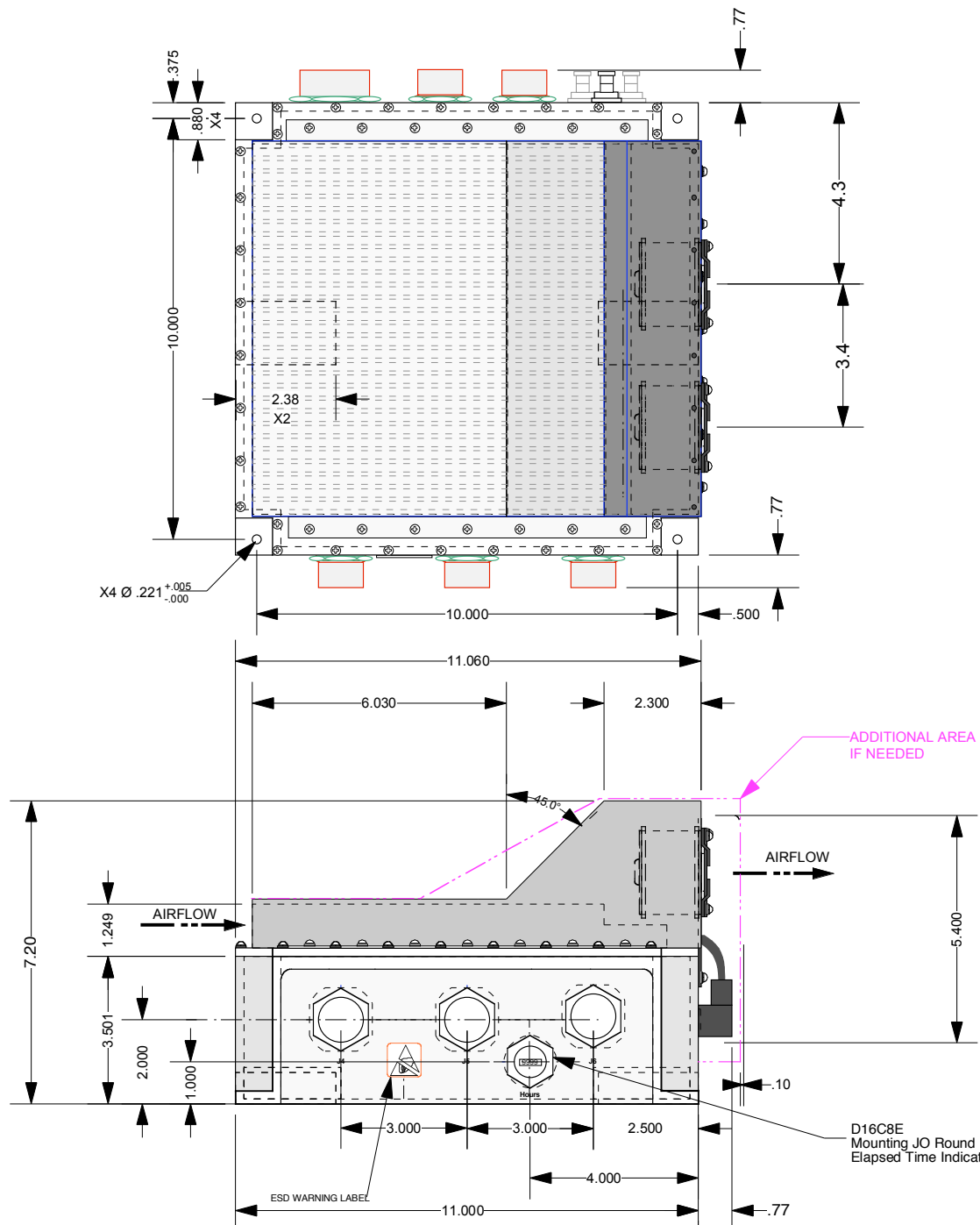
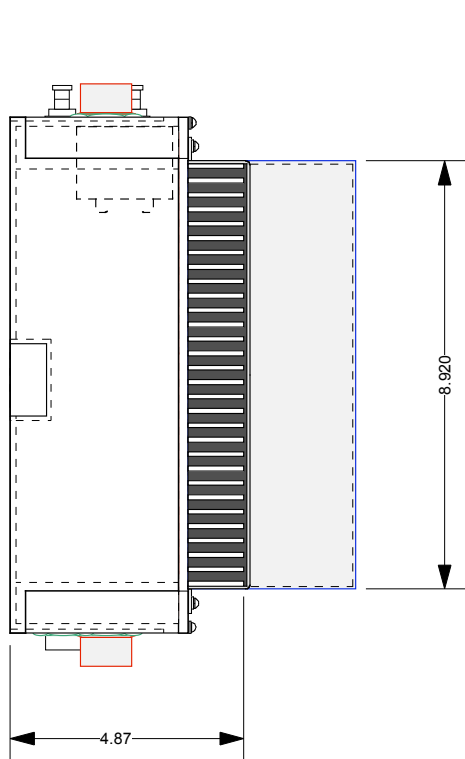
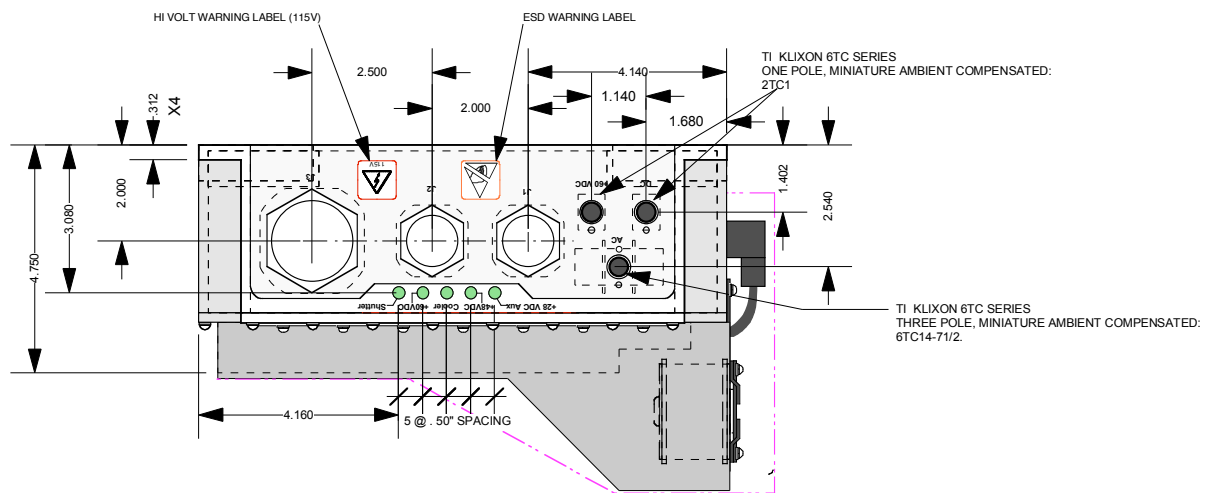

UNLESS OTHERWISE SPECIFIED
DIMENSIONS IN INCHES.
TOLERANCES ON:
Hole Diam ± .003 Angles ± 2°
Decimals .XXX ± .005
.XX ± .02

<i>Viable Power Conversion Technologies Inc.</i>			
DRAWN: M. Zadah	DATE: 18 FEB. 2005	DWG. NAME: PCU 1KW LAYOUT	
CHKD:	DATE:	INPUT: 115 VAC, 400 Hz, 3 PHASE, 28VDC, 100W.	
APPVD:	DATE:	OUTPUT: 60 VDC @ 1A, 48 VDC @ 5A, 28 VDC @ 0.65A, 28 VDC @ 12.5A, 28 VDC @ 4.1A, 28 VDC @ 6A, 28 VDC @ 3A.	
SIZE: B	SCALE: 1:4	CAGE: 3AJ03	DWG. No.: VOI 04048-00
REV.: A	SHEET: 1 of 1		